



RX - 5000Plus
RX - 7000Plus

Quick Installation Guide
All-In-One Energy Storage System

- This document is subject to change from time to time due to product upgrades or other reasons. This document is not a substitute for the user manual or safety instructions.
- Please read the user manual and related standards before undertaking any operation or commissioning. Please take time to access <http://www.redx.com.au> or scan the QR code for the latest quick installation guide.
- Prior to commencement, check whether the goods match the packing list, if there is any damage to any items or components missing, please contact the Distributor / Dealer or Redx.
- The power cables must be intact and well insulated. Please use insulating gloves and wear personal protective equipment at all times when installing this product.
- Failure to comply with any of the above requirements may result in injury to personnel or damage to equipment.

Redx shall not be liable for any loss of life or damage caused by failure to comply with the requirements of this document and user manual.

Safety Statement

Danger

- Shock hazard !
- Exposure to sunlight and the elements are not recommended.
- All electrical connections must meet local and national electrical standards.
- Only connect the system to the grid with local authority approval .
- Warranty will be void if the cover is removed. Improper opening of the unit may also result in serious electrical shock or injury to personnel.

Warning

All safety labels, warning labels, and nameplates must be clear and visible and cannot be removed or overwritten.

Warning

Hot surface!
Inverter module may become hot after extended period of operation. Allow time for inverter to cool before touching!

Notice

The country setting and protection parameters must be set by professional personnel based on local power grid standards.
Incorrect country settings may affect the operation failure to meet the local standard.

Warning Label



Disconnect all external power supplies before maintainance.



Hot surfaces !



Device has high voltage on AC input and AC output. Professional and qualified technicians are required to install this unit.



Read the instructions before operation.



Wait for 5 minutes before touching the internal conductive components after system turn off and disconnected from grid.

Packing List

RX-5000Plus / 7000Plus Standard Accessories



RX-5000Plus / 7000Plus

1PCS

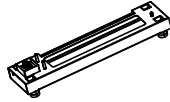

Base Components

1PCS



Side cover(right)

1PCS



Side cover(left)

1PCS

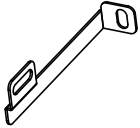

PCS bracket A

1PCS

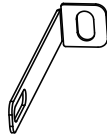

PCS bracket B

1PCS

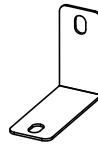

Base bracket

2PCS

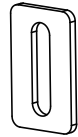

Battery Connecting buckle

2PCS

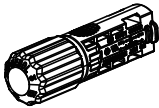

PV output connector

3PCS

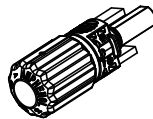

PV input connector

3PCS



RJ45 waterproof plug

4PCS

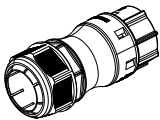

Generator

2PCS

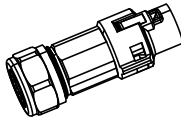

Grid Connector

1PCS

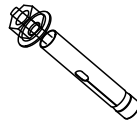

Expansion Bolts

4PCS

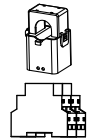

Smartmeter+CT

(Optional)
1PCS



Wi-Fi/4G Dongle

(Optional)
1PCS

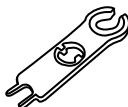

PV Tools

1PCS

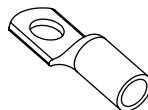

SC6-6

1PCS



Document

4PCS

Dimension

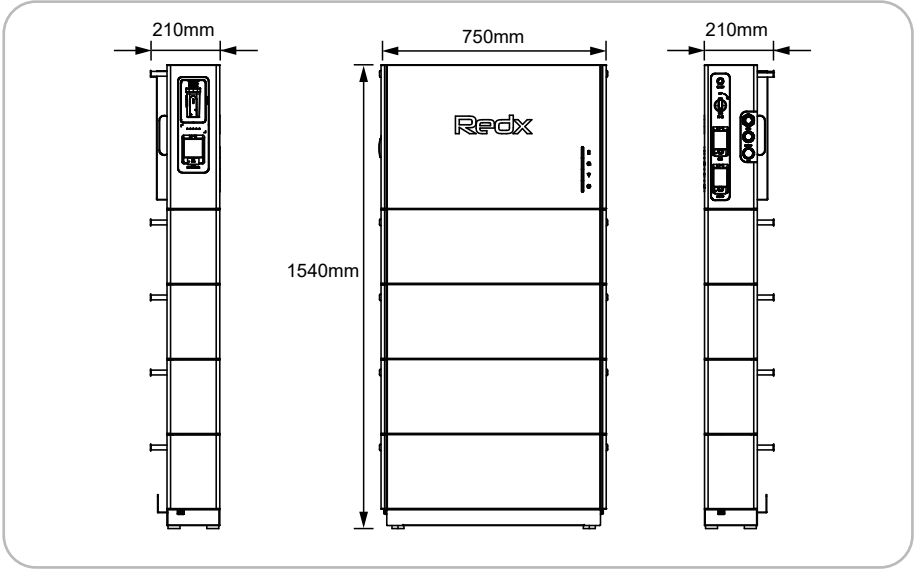

Installation Location

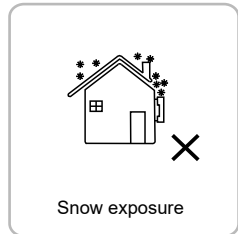
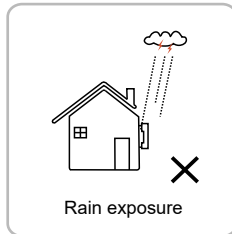
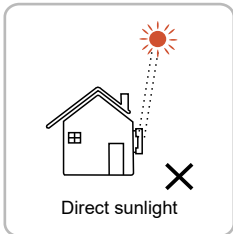
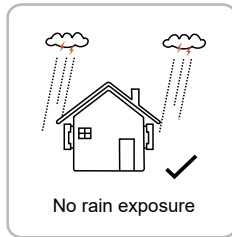
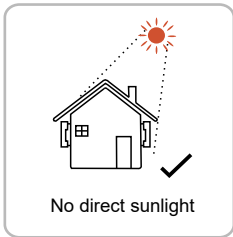

Pre - Operation Inspection

	Checking Items	Result	
		YES	NO
①	The installation location meets the requirement.	<input type="checkbox"/>	<input type="checkbox"/>
②	The system has been securely installed.	<input type="checkbox"/>	<input type="checkbox"/>
③	Sufficient space for heat dissipation. No objects are left in the system.	<input type="checkbox"/>	<input type="checkbox"/>
④	System wiring is normal and firm.	<input type="checkbox"/>	<input type="checkbox"/>
⑤	Cables are properly installed and well protected without any damage.	<input type="checkbox"/>	<input type="checkbox"/>
⑥	All terminals have been sealed.	<input type="checkbox"/>	<input type="checkbox"/>
⑦	Warning labels are not covered without alteration or occlusion.	<input type="checkbox"/>	<input type="checkbox"/>

Operation

Following the steps to start the system.

Step① : Connect 240V grid to inverter (if Grid available).

Step② : Connect PV to MPPT ports .

Step③ : Turn on the battery isolation circuit breakers.

Step④ : Turn on the inverter power button.

Step⑤ : Open the Redx Power App, complete all Installation steps in the App.

Installation

Avoid water and electricity when drilling, bit size $\varnothing 8\text{mm}$, drilling depth 40mm.

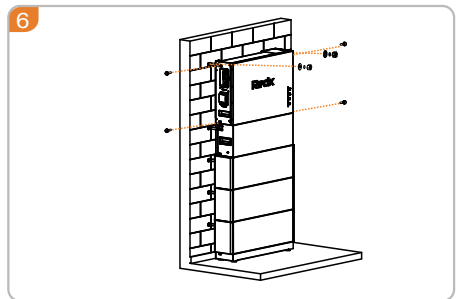
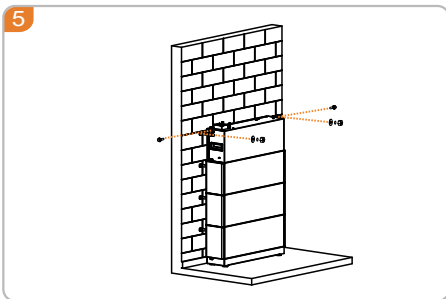
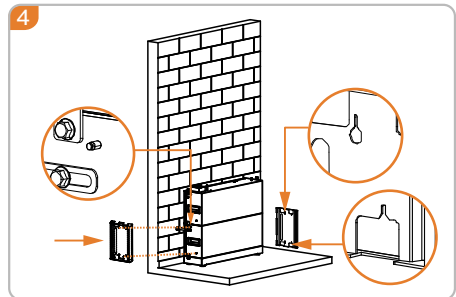
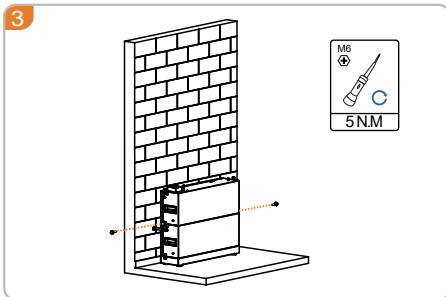
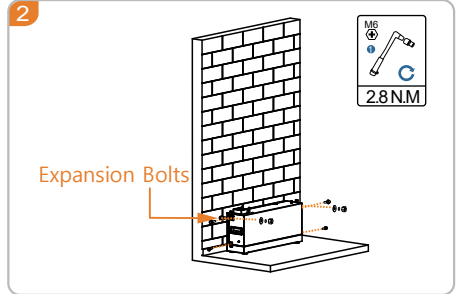
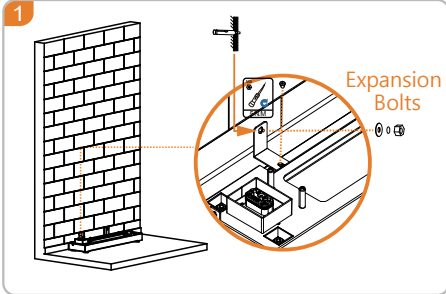

7 Refer to the electrical connection section for wiring

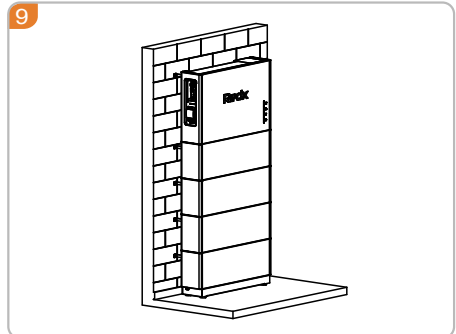
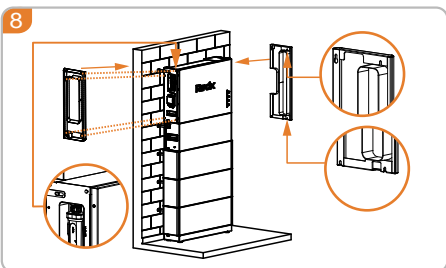

Port Instruction

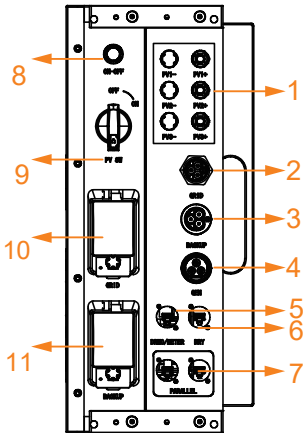

Items	Name
1	PV
2	GRID
3	BACKUP
4	GEN
5	DRMO / METER
6	DRY
7	PARALLEL
8	ON-OFF
9	PV SW
10	GRID BREAKER
11	BACKUP BREAKER
12	WIFI / 4G
13	BAT BREAKER
14	LED

PE Wiring

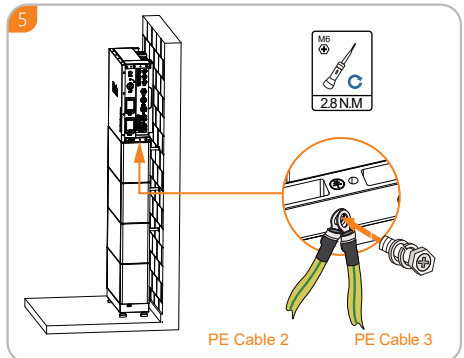
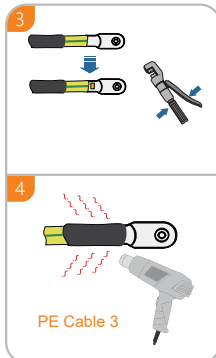
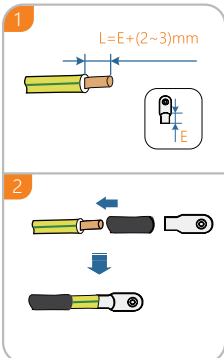

PV Connection

1 Positive metal terminal

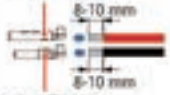

Negative metal terminal

2 PV-CZM-22100/19100



Ensure that the cable cannot be removed

3 Positive connector



Negative connector

4 Measuring voltage

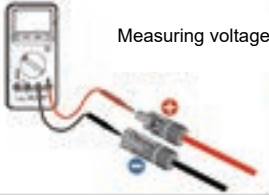

5 Use the open spanner to tighten the lock nut. If the spanner slips during tightening, it indicates that the lock nut is tightened

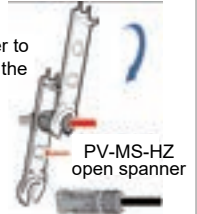

PV Arrays can be installed according to the needs of customers.
Each PV MPPT 120V-530V (550V, 15A, 3kW max).

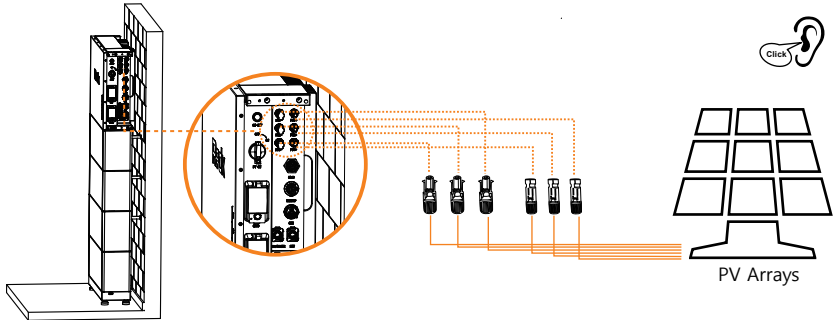

WiFi/4G Dongle

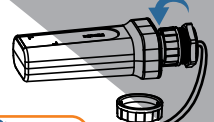
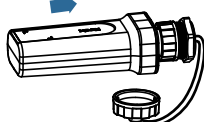
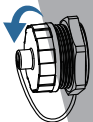

0.8-1.1N·m

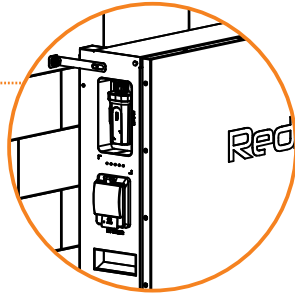
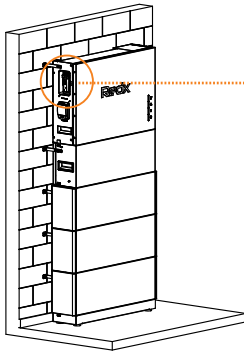

Tighten connector on the thread once Dongle is in.

Grid Connection

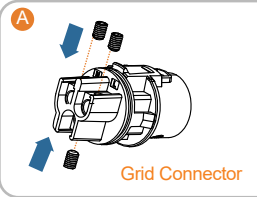
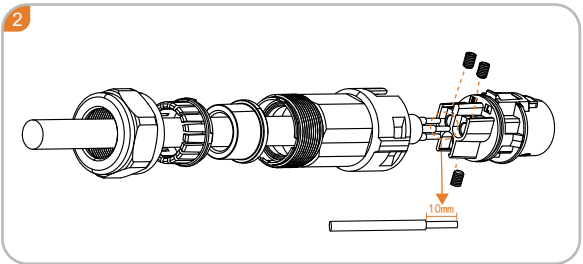
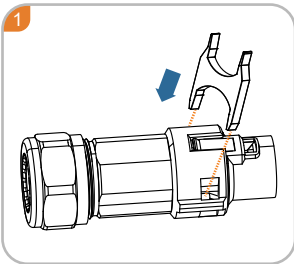

Grid Connector

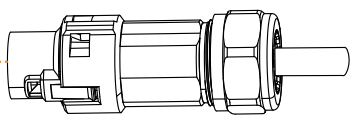
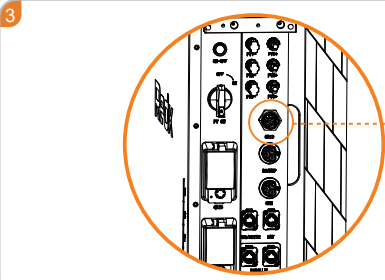
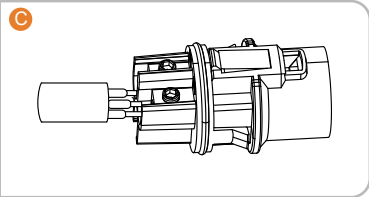
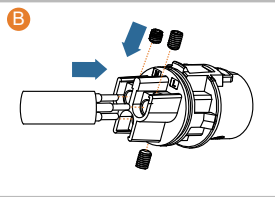

Load/Generator Connector

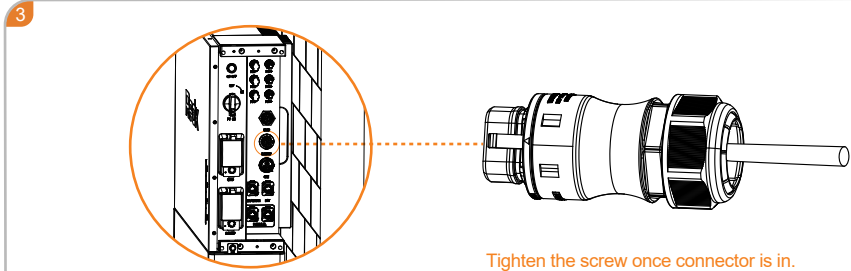
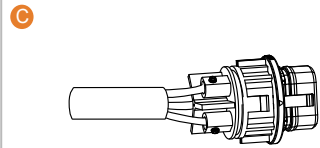
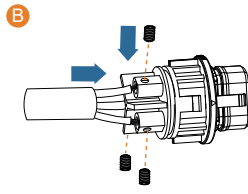
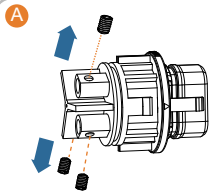
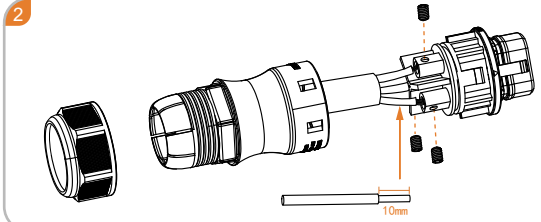
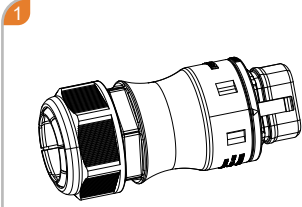

DRMO/METER, DRY, PARALLEL

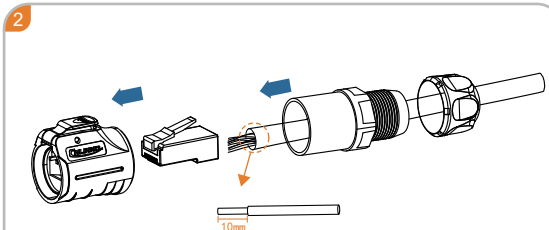
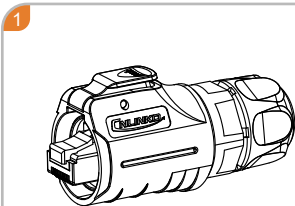

3

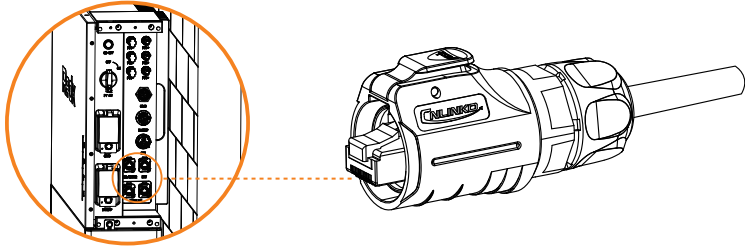

The dry contact is connected based on customer requirements

Dry Contact

Connect with weak current

Pin	Group	Definition
1	A1	NC
2	A2	DRY_1_NC
3	A3	NC
4	A4	NC
5	A5	DRY_1_COM
6	A6	NC
7	A7	NC
8	A8	DRY_1_NO

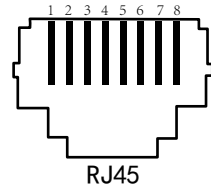



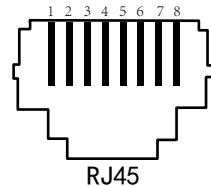

CT / Smart meter / DRM0

Smart meter 485, DRM0 signal, external CT

Pin	Group	Definition
1	A1	I_CT_IN-
2	A2	I_CT_IN+
3	A3	NC
4	A4	485_C_A
5	A5	485_C_B
6	A6	NC
7	A7	DMR0-
8	A8	DMR0+



LED Indicator

System Status	System Information	Display Logic			
		LED1 Battery	LED2 PV	LED3 Grid/Gen	Bi-colour
					LED4(Green/RED) Wifi/Ethernet/Fault 
Normal information	Power on	▲	▲	▲	▲
	Power off	■	■	■	■
	Promote update	/	/	/	/
	Promote update success	★	★	★	★
Battery	Battery not connected	■	/	/	■
	Battery in&discharge	●	/	/	/
	Battery low(Battery in&discharge)	★	/	/	/
	Battery charge	■	/	/	/
PV	Battery fault	■	/	/	●
	PV not connected	/	/	/	/
	PV not connected&work	/	●	/	/
	PV fault	/	■	/	●
Grid-Generator	Grid-Generator not connected	/	/	/	/
	Grid-Generator in&work	/	/	●	/
	Grid-Generator fault	/	/	■	●
External communication	Wifi-Ethernet not connected/Wifi-Ethernet	/	/	/	■
	Wifi-Ethernet connecting/Wifi-Etherne	/	/	/	■
	Wifi-Ethernet success connect&work/Wifi-Ethernet	/	/	/	●
Other important information	SOH low/SOH	/	/	/	■
	Permanent fault	■	■	■	■
	Idle	/	/	/	/
	System fault	/	/	/	●

Remark:

1、lamp-comment:

/: LED off/LED

●/●/●: LED on/LED

■/■/■: LED flash display-1Hz/LED-1Hz

★/★/★: LED flash display-2Hz/LED-2Hz

▲/▲/▲: LED light water display-2Hz/-2Hz

2、LED1/LED2/LED3/LED4 are displayed independently of each other during normal operation, and their functions can be stacked. If a fault is triggered, display it according to the faulty part.

LED1/LED2/LED3/LED4

SOC Led Indicate

Charging

SOC	L1 ●	L2 ●	L3 ●	L4 ●	L5 ●
0-20%	flash	off	off	off	off
21-40%	on	flash	off	off	off
41-80%	on	on	flash	off	off
61-80%	on	on	on	flash	off
81-100%	on	on	on	on	flash

Normal

SOC	L1 ●	L2 ●	L3 ●	L4 ●	L5 ●
0-20%	on	off	off	off	off
21-40%	on	on	off	off	off
41-80%	on	on	on	off	off
61-80%	on	on	on	off	off
81-100%	on	on	on	on	on

Notice

- If the startup fails, refer to "Troubleshooting" in the user manual.
- For details about LED indicators, refer to the user manual.

Description Of Energy Storage Capacity

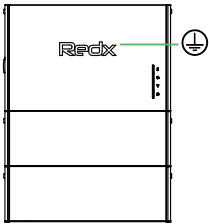
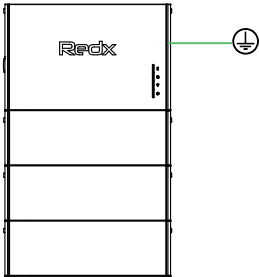
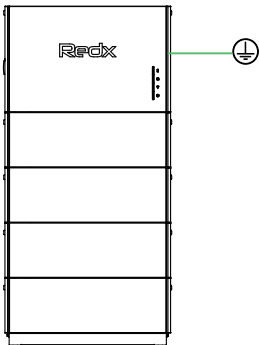
Power	Installation Method	List
6kWh (5006Plus / 7006Plus)		Inverter*1 Battery*2 Base*1
10kWh (5010Plus / 7010Plus)		Inverter*1 Battery*3 Base*1
13kWh (5013Plus / 7013Plus)		Inverter*1 Battery*4 Base*1



Redx App Download



Redx.com.au Downloads



Redx Power App Installer Manual



5000HY/7000HY User Manual
5000HY/7000HY Quick Installation Guide
5000HY/7000HY Warranty Card



Redx Power App User Manual



RX-0050 User Manual

Redx

The size and parameters of the product are subject to change without notice.
Rev 2024.05.16